

Replacement parts:

Sata MC-B N/HVLP Anodized Charcoal Gray/Royal Blue Sata MC-B Conventional Matte Nickel Plated

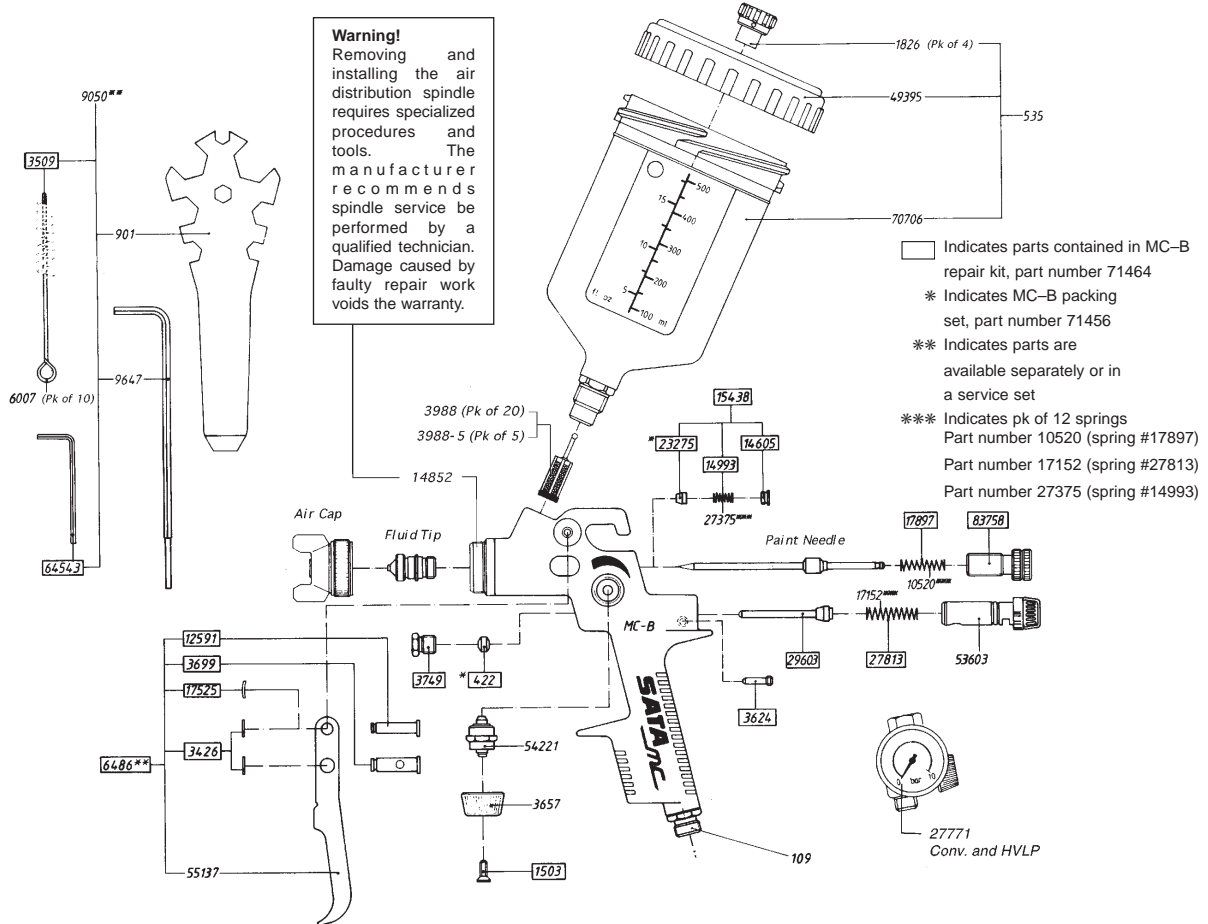

HVLP NOZZLE SETS

| Nozzle Size | MC-B N/HVLP |
|-------------|-------------|
| 1.4N | 52324 |
| 1.7N | 83600 |
| 1.9N | 64014 |
| 2.1N | 83618 |

CONVENTIONAL NOZZLE SETS

| Nozzle Size | MC-B |
|-------------|-------|
| 1.3mm | 80788 |
| 1.6mm | 80796 |
| 2.0mm | 80804 |
| NA(1.8) | 80812 |

Part # Description

| | |
|--------|-----------------------------------|
| 109 | Air inlet fitting, 1/4 BSP |
| 422 | Air piston packing |
| 901 | Spanner wrench |
| 1503 | Fan control screw |
| 1826 | Non-drip device, pk of 4 |
| 3426 | Circlip |
| 3509 | Cleaning brush |
| 3624 | Pin, micrometer |
| 3657 | Knob, fan control |
| 3699 | Pin, lower trigger |
| 3749 | Bushing, air piston |
| 3988 | Paint sieve, pk of 20 |
| 3988-5 | Paint sieve, pk of 5 |
| 6007 | Standard cleaning brush, pk of 10 |
| 6486 | Trigger service set |
| 9050 | Tool set |
| 9647 | Allen wrench, 4 mm |
| 10520 | Needle spring, pk of 12 #17897 |

| | |
|-------|--|
| 12591 | Pin, upper trigger |
| 14605 | Bushing, needle packing |
| 14852 | Air distribution spindle |
| 14993 | Spring, needle packing |
| 15438 | Needle packing service set, MC-B (Above S/N 025,000) |
| 16162 | Swivel |
| 17152 | Air piston spring, pk of 12 #27813 |
| 17525 | Spring Clip |
| 17897 | Spring, Needle |
| 23275 | Packing, needle |
| 27375 | Needle packing spring, pk of 12 #14993 |
| 27771 | Air micrometer with gauge |
| 27813 | Spring, air piston |
| 29603 | Air piston, complete |
| 49395 | Cup lid, 0.6 liter |
| 53595 | 0.6 liter plastic gravity cup |

| | |
|-------|----------------------------|
| 53603 | Air micrometer |
| 54221 | Fan control |
| 55137 | Trigger |
| 64543 | Allen wrench, 2 mm |
| 70706 | 0.6 liter cup, without lid |
| 71456 | Packing set, MC-B, MC-93 |
| 71464 | Repair kit, MC-B, MC-93 |
| 83758 | Fluid control |

PARTS FOR MC-93 AND MC-93 N/HVLP BELOW SERIAL NUMBER 025,000

| | |
|-------|-------------------------------|
| 1925 | 0.6 liter cup lid |
| 3715 | Spring, needle |
| 7633 | 0.6 liter plastic gravity cup |
| 7658 | 0.6 liter cup without lid |
| 17905 | Knob, fluid control |
| 71431 | Allen wrench, 4 mm |